

PRODUCT INFORMATION

Parts & Service

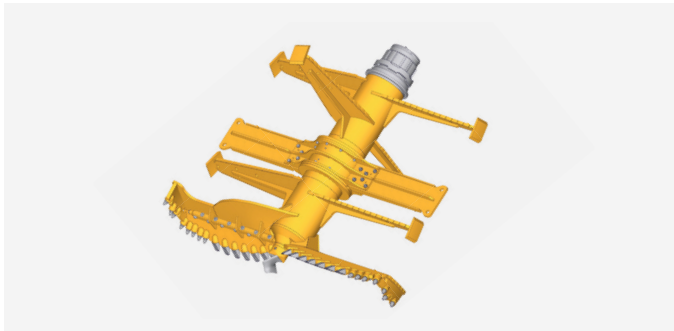

STARTER AFH-K2-S SCM – Mixing starter with stator paddle for clay



Advantages:

- Designed for top drilling performance
- Particularly long-lasting
- Innovative further development
- Individual application consulting
- Low-maintenance

Applications:

- Soils with clay content
- Uniformly layered subsoil condition

Features

Mixing paddle

- Rigid mixing paddle
- Stabilization with the borehole
- Integrated baffle plates at tips for more stability

Cutting geometries

- Double cut flat teeth starter
- Diameter-dependent mixing edge with flat teeth and round shank chisel

Stator paddle

- Pivoted
- Can be plugged variably in diameter
- To slow down the slurry

Bauer claw connector

- For maximum torque
- For maximum pulling force

Wear protection

- Specifically for highly stressed points
- Easy to replace
- Wear angles

Material quality

- High material standard
- Use of cast and forged parts depending on requirements

Slurry line

- Diameter 120 mm
- With an integrated slurry filter
- Diameter < 1,500 mm with central slurry lip
- Diameter < 1,500 mm with central slurry strip

Standard dimensions for SCM starter

Ø (mm)	254	368	470
800	x		
1,000	x		
1,200	x		
1,400	x		
1,500	x		
1,600		x	
1,800		x	
2,000		x	x
2,200		x	x
2,400		x	x
3,050			x

Working length = 2,500 mm | Other lengths and diameters on request.

CONTACT:

BAUER Maschinen GmbH

Parts & Service
Product Management Drilling Tools / Kelly Bars
BAUER-Strasse 1
86529 Schrobenhausen, Germany
Phone: +49 8252 97-0
BMA-Parts-and-Service@bauer.de
www.bauer.de

Go to
Dritoc



Go to
catalog



Available
worldwide

