

PRODUCT INFORMATION

Parts & Service

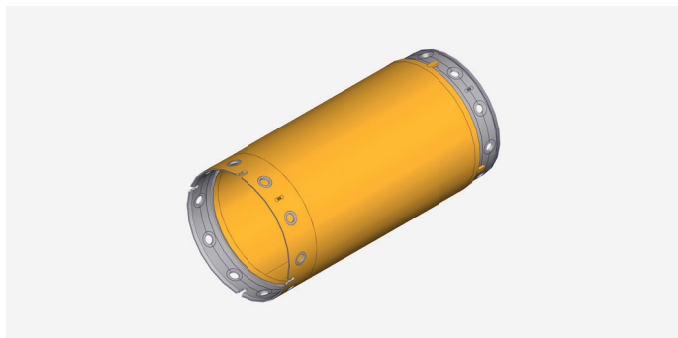

DW-S – Double-wall casing - Standard



Advantages:

- High quality and reliability
- High durability
- Utmost precision in manufacturing
- Individual application consulting
- Low-maintenance

Applications:

- Suitable for all soil layers

Features

Casing wall

- Double-walled
- Additional reinforcement
- Continuously smooth drill string > No catching of drilling tool

Spiral reinforcement

- Reinforcing bars between inner and outer casing
- Increased stability
- Higher dimensional stability in use with casing oscillators

Thread and conical rings

- Wear-resistant steel
- Easy to replace

Modular system

- Coordination to required drilling depth possible

High manufacturing quality

- Optimal circularity
- Optimal parallel construction
- Low wear and torque requirement

Material quality

- High material standard
- Use of cast and forged parts depending on requirements

Impermeable

- Thanks to optional sealing on the casing connectors
- Thanks to optional sealing on the casing screws

Feather keys

- For optimal positioning
- Easy orientation of casing screw holes
- Not for transmission of force

Standard dimensions

Length (mm)	Ø (mm)											
1,000	620	750	880	1,000	1,180	1,200	1,300	1,500	1,800	2,000	2,200	2,500
2,000	620	750	880	1,000	1,180	1,200	1,300	1,500	1,800	2,000	2,200	2,500
3,000	620	750	880	1,000	1,180	1,200	1,300	1,500	1,800	2,000	2,200	2,500
4,000	620	750	880	1,000	1,180	1,200	1,300	1,500	1,800	2,000	2,200	2,500
5,000	620	750	880	1,000	1,180	1,200	1,300	1,500	1,800	2,000	2,200	2,500
6,000	620	750	880	1,000	1,180	1,200	1,300	1,500	1,800	2,000	2,200	2,500

Other lengths and diameters on request.

CONTACT:

BAUER Maschinen GmbH

Parts & Service
Product Management Drilling Tools / Kelly Bars
BAUER-Strasse 1
86529 Schrobenhausen, Germany
Phone: +49 8252 97-0
BMA-Parts-and-Service@bauer.de
www.bauer.de

Go to
Dritoc



Go to
catalog



Available
worldwide

